

APPLICATION FOR ON-LICENCE OR RENEWAL OF ON-LICENCE



Form 3, sections 100 and 127(2), Sale and Supply of Alcohol Act 2012

Send or deliver your application to:

The Secretary
 District Licensing Committee
 Kāpiti Coast District Council
 Private Bag 60601, Paraparaumu 5254
 175 Rimu Road, Paraparaumu 5032
 Email: licence.application@kapiticoast.govt.nz
 Telephone (04) 296 4700 Toll Free: 0800 486 486

For Council use
File #

Once this application is complete you may make an appointment for a pre-lodgement meeting with a Licensing Inspector at the numbers given above.

Application forms cannot be accepted by the District Licensing Committee (DLC) over the counter until they have been signed off as complete by the Inspector and a fee category has been calculated. **Instructions on how to complete this application are included at the end of the form.**

This application is made in accordance with the particulars set out below:		
1. Application Type		
If you are not filing this renewal application, including paying the fee, at least 20 working days before the licence expires, provide a reason for the late filing as an attachment.		
<input type="checkbox"/> New On-Licence	<input checked="" type="checkbox"/> Renewal of On-Licence Licence number:	<input type="checkbox"/> Renewal of On-Licence with variation of conditions Licence number:
2. Endorsements		
Tick the appropriate box if you want to add an endorsement to the licence		
<input checked="" type="checkbox"/> Allow BYO	<input type="checkbox"/> On-Licence <u>plus</u> Caterer's On-Licence	
<input type="checkbox"/> BYO Licence <u>only</u>	<input type="checkbox"/> Caterer's On-Licence <u>only</u> (no restaurant)	
3. Details of Applicant		
Full legal name or names to be on licence (if a company, must be company name):		
Eastern Egret Limited		
Whether licence already held for premises or conveyance concerned: <input type="checkbox"/> Yes <input checked="" type="checkbox"/> No, and if 'Yes' state kind of licence		
4. Applicant Status: by reference to section 28 of Sale and Supply of Alcohol Act 2012		
<input type="checkbox"/> Natural person(s)	<input checked="" type="checkbox"/> Private Company	
<input type="checkbox"/> Body Corporate	<input type="checkbox"/> Public Company	
<input type="checkbox"/> Partnership	<input type="checkbox"/> Other (please specify).....	

5. For Applicant that is a Natural Person(s)

Full legal name:

Any aliases (and/or maiden name):

Usual residential address: Number

Street:

Suburb:

City:

Postcode:

Sex:

Occupation:

Date of birth:

Place of birth:

Telephone:

Mobile:

Email:

6. For Applicant that is a Body Corporate, Authority under which Incorporated**7. For Applicant that is Not a Natural Person(s), Details of Contact Person**

Name: Yutang Zhen

Designation/Position: Director

Telephone: 04 2934772

Mobile: 0221990991

Email: tong@easternegret.com

8. Postal Address for Service

Number/Street/PO Box: 4 Ngaio Road

Suburb: Waikanae

City:

Postcode: 5036

9. Business Details*Describe principal business, any other businesses***10. Criminal Convictions**

Does the applicant(s) have any criminal convictions (other than convictions for offences against provisions of the Land Transport Act 1998 not contained in Part 6, and offences to which the Criminal Records (Clean Slate) Act 2004 applies). Yes No, and if "Yes", then please provide nature of the offence, details of conviction, and penalty imposed.

11. For a Company whether Incorporated under the Companies Act 1993 or Equivalent Foreign Legislation

Full Legal Names of Directors:

Yutang Zhen

12. For a Private Company Incorporated under the Companies Act 1993

Authorised capital:	Paid up capital:
Name: Eastern Egret Limited	Address: Street number 4 Ngaio Road
Street: 4 Ngaio Road	Suburb: Waikanae
City: Waikanae	Postcode: 5036
Date of birth:	Place of birth:
Designation:	Face value of shares held: 100

13. For a Partnership

Full legal name of partner:		
Usual residential address: Number	Street:	
Suburb:	City:	Postcode:
Full legal name of partner:		
Usual residential address: Number	Street:	
Suburb:	City:	Postcode:

14. Details of Premises (if not a Conveyance)

Address: Number 4	Street: Ngaio Road	
Suburb: Waikanae	City:	Postcode: 5036

Trading Name: **Eastern Egret Restaurant****If not Owned by Applicant:**Tenure: *(state whether to be held as leasehold, or under tenancy agreement or licence)*Full legal name of owner: **Malcolm Roberston**

Address: Number	Street:	
Suburb:	City:	Postcode:

Is the licence conditional on completion of building work: Yes No, and if "Yes", state details:**15. Details of Conveyance**Kind: *(eg, ship, railway carriage, bus, etc)*Tenure: *(state whether owned by applicant, or to be operated under charter, lease, or licence)*

If not Owned by Applicant:

Full legal name of owner:

Address: Number

Street:

Suburb:

City:

Postcode:

Any registration number:

Any home base address:

Any name used or proposed for conveyance:

Is the licence conditional on completion of construction work: Yes No, and if "Yes", state details:**16. Details of Duty Manager(s)/Proposed Manager(s) *If more than two certified managers please attach details separately***

Full legal name: Yutang Zhen

Number of manager's certificate: 45/CERT/1264/2025

Expiry Date: 03/03/2026

Full legal name: Sally Marion Rosson

Number of manager's certificate: 45/CERT/496/2016

Expiry Date: 29/11/28

17. Business DetailsState the general nature of the business to be conducted by applicant in the premises if licence granted: *(for example, hotel, tavern, restaurant, entertainment/nightclub)*

Licenced Restaurant

Is the sale of alcohol intended to be the principal purpose of business: Yes No and advise the intended principal purpose of business *(for example: sale of food; entertainment; accommodation)*.

Sale of alcholo, sale of Food, sale of Non Alcohol drinks

Is the applicant engaged, or intending to be engaged, in the sale or supply of any goods other than alcohol, non-alcoholic refreshments and food, or in the provision of any services other than those directly related to the sale or supply of alcohol and non-alcoholic refreshments, and food: Yes No - and if "Yes", advise the nature of other goods or services. *This is to assess whether other goods and services provided are compatible with the sale of alcohol.*

State the days and hours proposed for sale of alcohol (*this is licensed hours not trading hours*):

Monday to Sunday, 11 AM to Midnight

Do you have, or require, a Trading in Public Place licence to permit consumption of alcohol on footpath: Yes No If 'Yes', please attach and number #.....

18. Conditions

- Write answer below or attach relevant documents that demonstrate compliance.
- When including attachments please number the documents, circle 'Yes' and write the document number on '#.....'

**Doc attached?
Number.**

Describe experience and training of applicant:

2005 - 2010 Nanking Restaurant Dunedin
Dec 2024 - Present working as Duty Manager at Eastern Egret Restaurant

Yes / No
#.....

Describe the type and range of food intended to be available for purchase:

Full Menu attached

Yes / No
#.....

Describe the type and range of non-alcoholic beverages intended to be available for purchase:

Zero Beer, Coke, Lemonade, and fruit juice

Yes / No
#.....

Describe the type and range of low-alcohol (2.5% ABV) beverages intended to be available for purchase (list the brands):

Light Beer/ Heinken Zero

Yes / No
#.....

Describe to what extent, and where, drinking water is intended to be freely available to patrons (if no access to mains water supply, also advise the potability of water intended to be available):

Bottle of water supplied on table as soon as diners arrive at table

Yes / No
#.....

<p>Describe the steps proposed to be taken to prevent the sale and supply of alcohol to prohibited people:</p> <p>Any persons who looks 25 years or under will be asked for ID Signage: No service to anyone who is intoxicated No ID - No Service Alcohol will not be served to Minors</p>	<p>Yes / No #.....</p>
<p>Describe any other steps the applicant proposes to promote the responsible consumption of alcohol (for instance host responsibility practices):</p> <p>Attached host responsibility</p>	<p>Yes / No #.....</p>
<p>Describe any other systems (including training systems), and staff in place (or to be in place) for compliance with the Act:</p> <p>Familiarist staff with the intoxication tool SCAB Speech, Coordination, Apperance, Behaviour</p>	<p>Yes / No #.....</p>
<p>Describe any actions that have been taken to ensure the good order and amenity of the locality would not be likely to be:</p> <ul style="list-style-type: none"> reduced, by more than a minimal extent, by granting the licence; or increased, by more than a minimal extent, by the refusal to renew the licence. <p><i>This includes issues such as noise (including amplified music, people in outdoor areas or arriving or leaving premises), the effects on sensitive users within locality such as pre-schools, schools and medical centres:</i></p> <p>No amplified music available No school etc in the vicinity</p>	<p>Yes / No #.....</p>
<p>For Licence Renewal Only: Describe any conditions of the licence the applicant seeks to vary or cancel: <i>To be filled in for each condition the applicant seeks to vary or cancel – attach additional pages as necessary</i></p> <p>Terms of condition at present:</p> <p>Action sought: <input type="checkbox"/> Variation <input type="checkbox"/> Cancellation. If Variation, in what respect does the applicant seek to vary the condition?</p>	<p>Yes / <input checked="" type="checkbox"/> NO #..... #..... #..... #.....</p>

Full reasons for variation or cancellation:		
19. Attachments (if Not a Conveyance)		Doc attached? Number.
<ul style="list-style-type: none"> When including attachments please number the documents, circle 'Yes' and write the document number on '#.....' 		
A statement, or signed declaration, regarding the premises need for an evacuation scheme, as set out in section 100(d) of the Act for new applications, or section 127(e) of the Act for renewals. <i>The Declaration of Evacuation Scheme template is available on the Council website.</i>		Yes / No #... 8 ... Attached
Copy of planning consent: Please attach certificate to show that the proposed use meets the requirements of the Resource Management Act 1991. <i>Not required for renewal unless the business activity or type has changed since the last version.</i>		Yes / No #.....
Copies of all relevant building certificates consents: Please attach certificate to show that the proposed premises meet the requirements of Building Code 2004. <i>Not required for renewal unless structural changes have been undertaken since the last issue or renewal.</i>		Yes / No #.....
A scale floor plan showing the licensed area and, if applicable, each area to be designated as a supervised area or restricted area, and the principal entrance. <i>If this is a renewal application, include your existing 'approved alcohol licensed area' and check for any changes.</i>		Yes / No #... 7 ... Attached
For body corporate applicant, please attach a copy of certificate of incorporation (or equivalent document). <i>Not required for renewal unless changes have occurred since the last issue or renewal.</i>		Yes / No #.....
Advise if a Crime Prevention Through Environmental Design (CPTED) assessment has been undertaken or any improvements to the design and layout in accordance with CPTED. <input type="checkbox"/> Yes <input type="checkbox"/> No, and if 'Yes' attach a copy, and if 'No' complete a CPTED checklist (<i>see HPA and the Ministry of Justice websites for more information</i>).		Yes / No #.....
Please attach a photograph or artist's impression of the exterior of the proposed premises. <i>Not required for renewal unless major changes have been undertaken since the last issue or renewal.</i>		Yes / No #.....
Please attach a map showing the location of the premises. <i>Not required for renewal.</i>		Yes / No #.....
For the following documents, if they are already attached in response to a previous section you do not need to provide twice. Just circle the 'Yes' and repeat the document number you have given it.		
Please attach a copy of your Host Responsibility Policy.		<input checked="" type="checkbox"/> / No #Attached
Please attach a copy of a sample food menu.		<input checked="" type="checkbox"/> / No #Attached
If the premises are owned by another party, please attach an owner's statement or copy of lease to show there is no objection from the owner to the issue of a licence for the proposed premises. <i>Not required for a renewal unless the lease or ownership arrangements have changed.</i>		Yes / No #.....

20. Attachments (Conveyance)		Doc attached? Number.
<ul style="list-style-type: none"> When including attachments please number the documents, circle 'Yes' and write the document number on '#.....' 		
A scale floor plan showing the licensed area and, if applicable, each area to be designated as a supervised area or restricted area, and the principal entrance.		<input checked="" type="checkbox"/> Yes / No #...5... Attached
For body corporate applicant, copy of certificate of incorporation (or equivalent document). <i>Not required for renewal unless changes have occurred since the last issue or renewal.</i>		Yes / No #.....
Please attach a photograph or artist's impression of the exterior of the conveyance. <i>Not required for renewal unless major changes have been undertaken since the last issue or renewal.</i>		Yes / No #.....
For the following documents, if they are already attached in response to a previous section you do not need to provide twice. Just circle the 'Yes' and repeat the document number you have given it.		
Please attach a copy of your Host Responsibility Policy.		<input checked="" type="checkbox"/> Yes / No #...4... Attached
Please attach a copy of a sample food menu.		<input checked="" type="checkbox"/> Yes / No #...1... Attached
If the conveyance is owned by another party, please attach an owner's statement or copy of lease to show there is no objection from the owner to the issue of licence to this conveyance. <i>Not required for a renewal unless the previous lease has expired.</i>		Yes / No #.....
21. Further details when Applicant is a Company		
<i>Include full details of each person who holds 20% or more of the shares, or of any particular class of shares, issued by the company.</i>		
Name:	Address:	
Suburb:	City:	
Postcode:	Date of birth:	
Place of birth:	Designation:	
Name:	Address:	
Suburb:	City:	
Postcode:	Date of birth:	
Place of birth:	Designation:	
Name:	Address:	
Suburb:	City:	
Postcode:	Date of birth:	
Place of birth:	Designation:	
Are additional sheets attached? Yes / No - Doc number #.....		

22. Further details when Applicant is a Partnership

Name:	Address:	
Suburb:	City:	
Postcode:	Date of birth:	
Place of birth:	Date:	Signature:
Name:	Address:	
Suburb:	City:	
Postcode:	Date of birth:	
Place of birth:	Date:	Signature:
Name:	Address:	
Suburb:	City:	
Postcode:	Date of birth:	
Place of birth:	Date:	Signature:

Are additional sheets attached? Yes / No - Doc number #.....

23. Signature of Applicant (this must be signed by applicant not their agent)

I authorise New Zealand Police to disclose any personal information it considers relevant to my application to the Medical Officer of Health and/or the Licensing Inspector for the purpose of assessing my suitability.

Name: Yutang Zhen

Date: 20/01/2026

Signature:



Dated at location: Waikanae

Privacy Statement

Information contained in your application and any supporting information will be held by Kapiti Coast District Council to enable your application to be processed under the Sale and Supply of Alcohol Act 2012. This information will be made available to the public on request. The information will be provided to the Kapiti Coast District Licensing Committee, the NZ Police, the Medical Officer of Health and Council's Licensing Inspectors. This information may form part of a public hearing of your application before the Kapiti Coast District Licensing Committee and may be used in the Committee's decision for your application. Decisions will be made publicly available.

Council is required to keep a statutory register of all applications and the District Licensing Committee's decisions on them. Council is required to report statistics about applications to the Alcohol Regulatory and Licensing Authority. Any member of the public may request access to this information under the Local Government Official Information and Meetings Act 1987. This information may also be used under the Privacy Act 1993. You have the right to see and correct personal information that Council holds about you.

Method of payment (must be made at time of application)

- I have paid at a Kāpiti Coast District Council Service Centre when I delivered this application.
- I have paid by electronic transfer (Council Bank Account Number: 03-0732-0306101-00) and quoted my name and “alcohol” in the reference fields; and
 - I have included proof of electronic payment with this application.

How I would like to receive my alcohol licence (please select one only)

- I will collect the alcohol licence – please contact me when it is ready by Phone or Email
- OR
- Please email the alcohol licence to me.

Next Step: Once your application is complete, if you would like to make an appointment for an optional pre-lodgement meeting with the Licensing Inspector then please Telephone (04) 296 4700 or Toll Free: 0800 486 486.

After your application is lodged

Public Notices

You are responsible for giving notice within 20 working days of the Council formally accepting your application (or 10 working days if it is an application for renewal) and the Council will send you a template to approve. The notice and application will be made available on the Public Notices page of Council’s website for a period of 25 working days. A copy of this notice must also be displayed in a conspicuous place on the premises or conveyance to which this application relates for the period of public notification.

Guidance for Completing On-Licence Application Form

Background

The object of the Sale and Supply of Alcohol Act 2012 is that the sale, supply, and consumption of alcohol should be undertaken safely and responsibly; and the harm caused by the excessive or inappropriate consumption of alcohol should be minimised.

It is a legal requirement of the Sale and Supply of Alcohol Act 2012 that you must have a licence before you can sell or supply alcohol.

Before lodging application

If your application for a NEW licence is regarding 'premises - not a conveyance', you must also apply for certificate of compliance with the Resource Management Act and the Building Act from the Kapiti Coast District Council. A 'conveyance' means an aircraft, coach, ferry, hovercraft, ship, train, or other vehicle, used to transport people.

Completing your application

Who should complete which fields

Completing your application		Who should complete which fields
1	Type of Application	All applicants to complete.
2	Endorsements	Only complete if seeking an endorsement for BYO or Caterer. This is for restaurants who only allow BYO and caterers who also have a restaurant or only cater.
3	Details of Applicant	All applicants to complete. If a company receives profits then apply in company name.
4	Applicant Status	All applicants to complete.
5	For Applicant that is Natural Person(s)	Only complete if applicant is a natural person. A natural person is an individual. Complete all sections.
6	For Applicant that is Body Corporate	Only complete if applicant is a body corporate.
7	For Applicant that is <u>not</u> a Natural Person(s)	Only complete if applicant is a body corporate, partnership, private company or public company. Complete all sections.
8	Postal Address for Service	All applicants to complete.
9	Business Details	What is your principal business? For example restaurant, entertainment centre, sale of alcohol (ie tavern).
10	Criminal Convictions	Convictions of applicant directors or shareholders. All applicants to complete.
11	For a Company full legal names of directors	Only complete if applicant is a public or private company.
12	For a Private Company	Only complete if applicant is a private company incorporated under the Companies Act 1983.
13	For a Partnership	Only complete if applicant is a partnership.
14	Details of Premises (if not a conveyance)	<p>All applicants must complete either 14 or 15.</p> <p>A 'conveyance' is premises which are used to transport people such as an aircraft, coach, ferry, hovercraft, ship, train, or other vehicle.</p> <p>A 'premises - not a conveyance', are any other type of premises (building) for which you are seeking a licence.</p>
15	Details of Conveyance	
16	Details of Duty Manager(s)/Proposed Managers	All applicants to complete. If more than 2 please attach details separately.
17	Business Details	All applicants to complete.

18	Conditions	All applicants to complete.
19	Attachments (if not a conveyance)	All applicants must complete either 19 or 20 (see 14/15).
20	Attachments (conveyance)	
21	Further Details where Applicant is a Company	Only complete if private or public company.
22	Further Details where Applicant is a Partnership	Only complete if a partnership.
23	Signature of Applicant	All applicants to complete.

EASTERN EGRET. BAR LAYOUT

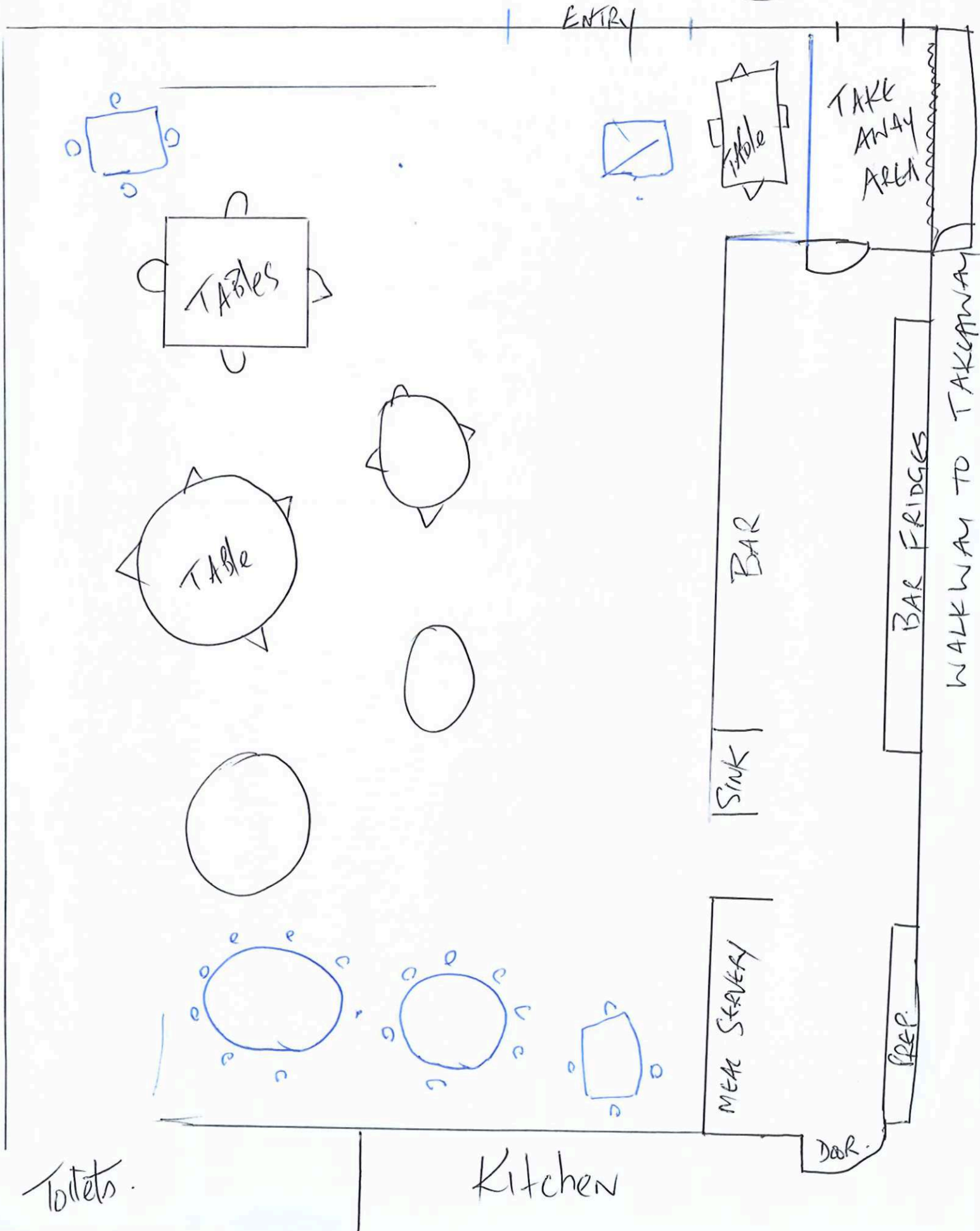
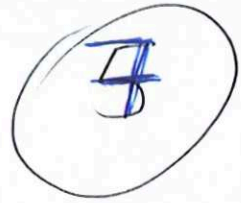

Host Responsibility of Intent

.....Management and staff welcome you

4

We wish to ensure that all our customers enjoy themselves and we encourage responsible drinking practices.

- Those under 18 years old will not be served alcohol; please do not be offended if identification is requested.
- Low alcohol beer is available.
- We offer a range of fruit, non alcoholic and hot beverages.
- Intoxicated and aggressive persons will be asked to leave the premises.
- Food is available during opening hours.
- This is a non-smoking environment; there are seats by the bus stops outside for smokers.
- We will dial a taxi or Drive 4 U for your convenience.

Please be our guest 😊. We will endeavour to make your stay a pleasant one.

Approved Plan of alcohol licensed area

Eastern Egret Limited, 4A Ngaio Road, Waikanae, known as Eastern Egret Restaurant

The Eastern Egret

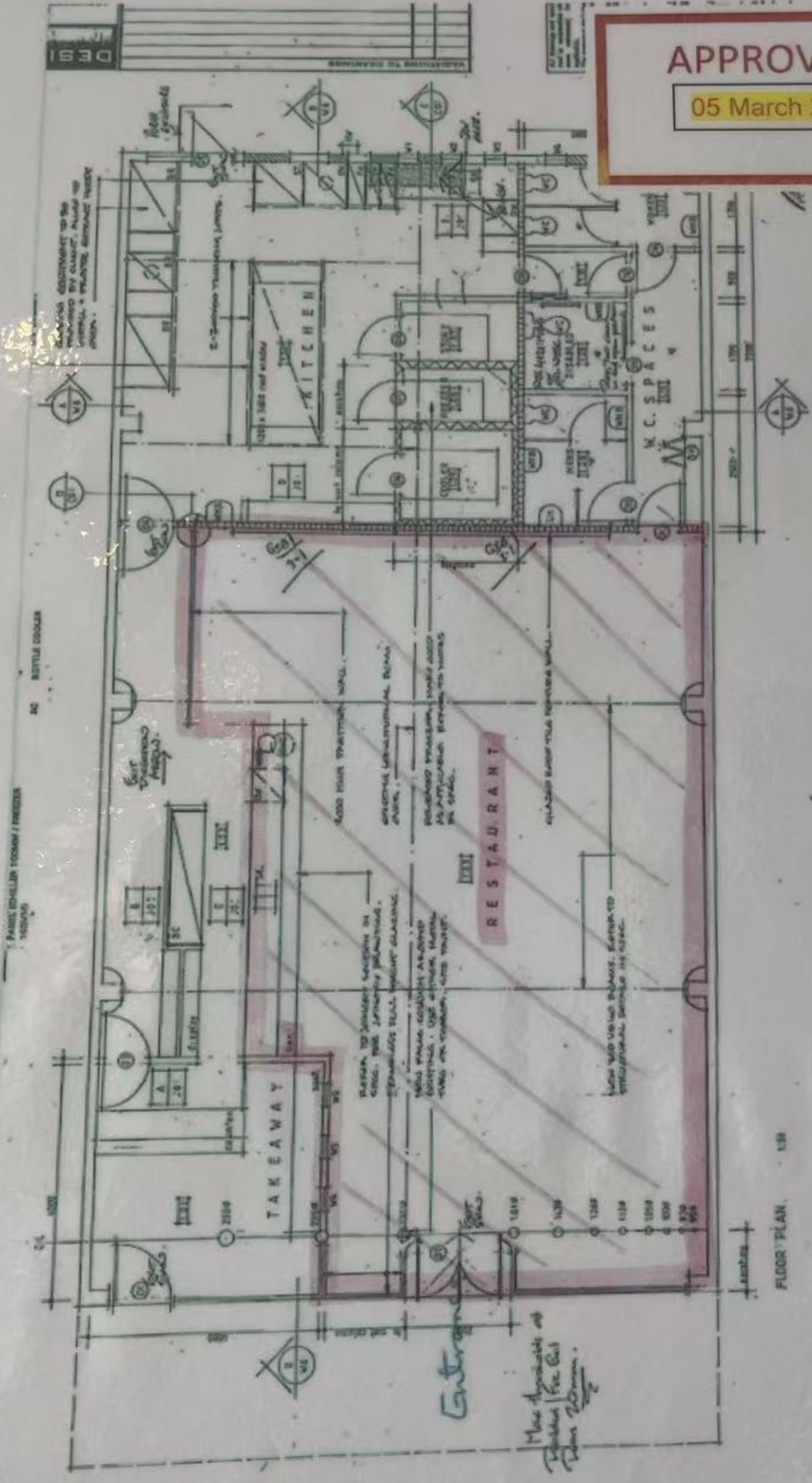

/// Licensed Area

Entrance

*More Appointments at
Building / Pic. Call
Tara Brown*

**Please inform us if you have
any allergies**

Are you

Celiac

Gluten Free

Vegan

Dairy Free

Or have dietary requirements

**As we can adapt to your
needs.**

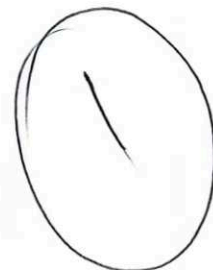

SHARRON'S EASTERN EGRET

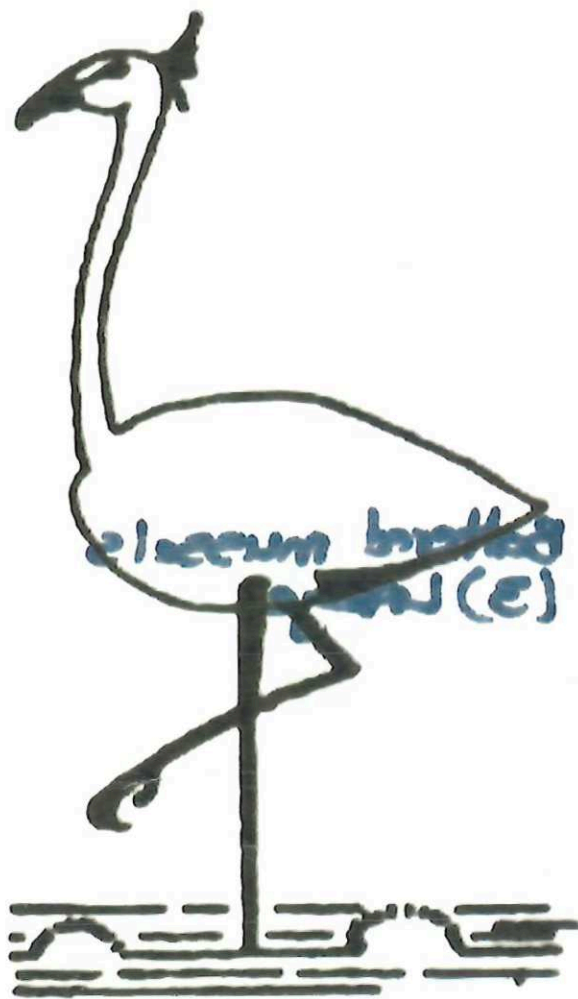

015

placemum hatched so because
(E)

APPETISERS

Spring Rolls (3)	\$9.00
Deep Fried Wonton (6)	\$9.00
Pork Balls (4) Dim sims	\$9.00
Honey BBQ Pork	\$9.00
Deep Fried Squid	\$9.00
Deep Fried Scallops (4) Battered or Crumbed	12.50
Crumbed King Prawns (4)	12.00
Garlic King Prawns (4)	12.00
Crumbed OR Battered mussels (3) Large	\$12.-

SHARING PLATTERS

Happiness Platter	\$9.-
Pork Balls, Spring Rolls, Deep Fried Wontons & BBQ Pork	Per Person
Seafood Platter	\$12.00
Garlic Prawns, Battered Scallops, Crumbed Prawns & Deep Fried Squid	Per Person

SOUP

Chicken & Sweetcorn Soup	\$10.00
Wonton Soup	\$10.00
BBQ Pork Wonton Soup	\$10.00
Spicy, Hot & Sour Beancurd Soup	\$10.00

VEGETARIAN APPETISERS

Crumbed Broccoli & Cauliflower	\$8.00
Deep Fried Tofu	\$8.00
Crumbed Vegetarian Mushrooms	\$8.00

CHICKEN

Chicken Seasonal Vegetables & Cashew Nuts Served in a Potato Basket	\$28 —
Chicken in Oyster Sauce & Vegetables	\$28 —
Chicken With Bean sprouts	\$28 —
Chicken With Capsicums & black Bean Sauce	\$28 —
Chicken With Pineapple & Pickled Ginger	\$28 —
Chicken With Ginger & Spring Onions	\$28 —
Canton Style Crispy Chicken	\$28 —
Chicken in Lemon Sauce	\$28 —
Chicken in Sweet & Sour Sauce	\$28 —
Honey Chicken Fillet	\$28 —
Chicken in Red Wine Sauce	\$28.00
Chicken Pad Thai	\$29 00
Sweet & Sour Chicken Served on a Sizzling Hotplate	\$30 —

PORK

Pork Seasonal Vegetables & Cashew Nuts Served in a Potato Basket	\$28 →
Pork in Oyster Sauce & Vegetables	\$28 =
Pork With Capsicums & black Bean Sauce	\$28 -
Pork With Pineapple & Pickled Ginger	\$28 -
Pork With Ginger & Spring Onions	\$28 =
Sweet & Sour Pork with Pineapple	\$28 -
Honey Pork Fillet	\$28 -
Crumbed Mushrooms Stuffed with Pork	\$28 -
Pork Loins in Red Wine Sauce	\$29 -

BEEF

Beef Seasonal Vegetables & Cashew Nuts Served in a Potato Basket	\$28 -
Beef in Oyster Sauce & Vegetables	\$28 -
Beef With Capsicums & Black Bean Sauce	\$28 -
Beef With Pineapple & Pickled Ginger	\$28 -
Beef With Ginger & Spring Onions	\$28 -
Orange Beef	\$28 -
Beef Ho Fung	\$29 -
Oriental Style Steak Served on a Sizzling Hotplate	\$30 -
Sweet & Sour Steak Served on a Sizzling Hotplate	\$30 -
Black Peppercorn Steak Served on a Sizzling Hotplate	\$30 -
Red wine Sauce Steak Served on a Sizzling Hotplate	\$30 -

SEAFOOD

King Prawns With Vegetables & Cashew Nuts	\$30.00
Served in a Potato Basket	
King Prawns With Capsicums & Black Bean Sauce	\$30.00
King Prawns in Sweet & Sour Sauce	\$30.00
Honeyed Sesame King Prawns	\$30.00
Scallops With Seasonal Vegetables & Cashew Nuts	\$30.00
Served in a Potato Basket	
Squid With Seasonal Vegetables & Cashew Nuts	\$28.00
Squid With Capsicums & Black Bean Sauce	\$28.00
Fish With Capsicums & Black Bean Sauce	\$28.00
Fish with Sweet & Sour Sauce	\$28.00
Fish in Lemon Sauce	\$28.00
Fish in Oyster Sauce & Vegetables	\$28.00
Fish in Garlic Butter Sauce & Vegetables	\$28.00
Combo Seafood Basket Stirfried , Wok	\$34.00
Deep Fried, Crumbed or Battered	\$34.00

DUCK

Roast Duck (Traditional With Bones)	\$35.00
Duck with Melon in a Tropical Fruit Sauce	\$35.00
Duck with Pineapple in a tropical Fruit Sauce	\$35.00
Duck with Assorted Meat, Seafood & Vegetables	\$45.00

EGG FU YOONG (Omelette)

Pork	\$28 --
BBQ Pork	\$28 --
Beef	\$28 -
Chicken	\$28 --
Combination Meat Chicken, Pork, Beef, BBQ Pork	\$28 --
Prawns	\$32 -
Scallops	\$32 -
Combination Seafood Fish, Scallops, Prawns, Squid	\$32 -

TOFU (Beancurd)

Soft Tofu Szechwan Style With Meat Shrimp & Mushrooms	\$29.00
Deep Fried Tofu With Assorted Meat, Seafood & Vegetables	\$38.00
Deep Fried Tofu Szechwan style With Vegetables	\$29.00

FRIED RICE

Egg	\$22.00
Pork	\$25.00
BBQ Pork	\$25.00
Beef	\$25.00
Chicken	\$25.00
Combination Meat Pork, BBQ Pork, Chicken & Beef	\$25.00
Yeung Chow Shrimp & BBQ Pork	\$25.00
Steamed White Rice (Per Bowl)	\$4.00

CHOW MEIN (With Noodles)

CHOP SUEY (Without Noodles)

Pork	\$28.00
BBQ Pork	\$28.00
Beef	\$28.00
Chicken	\$28.00
Combination Meat	\$28.00
Pork, BBQ Pork, Chicken & Beef	
Combination Seafood	\$34.00
Fish, Scallops, Prawns, Squid	

HOT & SPICY

Nasi Goreng (Rice) Pork, Beef, Chicken or Combo Meat	\$28.00
Bami Goreng (Noodles) Pork, Beef, Chicken or Combo Meat	\$28.00
Szechwan Pork, Chicken or Beef & Vegetables	\$28 -
Satay Pork, Chicken or Beef with Vegetables	\$28 -
Thailand Style Chicken	\$26 -
Thailand style Honey Fish with Vegetables	\$28 -
Beef Mushrooms in Hot Bean Sauce	\$28 -
Spicy Prawns With Chili & Garlic	\$30 -
Spicy Pork Loins with Chili & Garlic	\$30 -
Spicy Squid with Chili & Garlic	\$30 -

VEGETARIAN (No meat)

Vegetarian Fried Rice	\$25.00
Vegetarian Chow Mein (With Noodles)	\$28.00
Vegetarian Chop Suey (Without Noodles)	\$28.00
Vegetarian Bami Goreng (Spicy)	\$28.00
Vegetarian Nasi Goreng (Spicy)	\$28.00
Vegetarian Egg Fu Yoong (Omelette)	\$26.00
Tofu Seasonal Vegetables	\$28.00
Szechwan Tofu Vegetables (Spicy)	\$28.00
Vegetarian Mushrooms (Crumbed)	\$26.00
Seasonal Vegetables and Cashew nuts Served in a Potato Basket	\$28.00
Vegetables in Satay Sauce	\$28.00
Vegetables With Oyster Sauce	\$28.00
Vegetables in Black Bean Sauce	\$28.00
Vegetables in Garlic Sauce	\$28.00

NON ALCOHOLIC BEVERAGES

\$6.00

Coke, Diet Coke, Coke zero

2

Fanta, L&P, Sprite Sparkling Duet

Raspberry Coke/Lemonade

Bundaberg Range

Ginger beer/Ginger Ale

Lemon Lime & Bitters

Apple Juice

Pineapple Juice

Grapefruit Juice

Tomato Juice

Orange Juice

DESSERTS

\$12.00

Ice Cream Sundaes

Chocolate, Caramel, Strawberry or Passionfruit

Deep Fried Ice Cream

Chocolate or Caramel

Deep Fried Banana + Ice cream

Chocolate, Caramel, Strawberry or Passionfruit

Lychee & Ice Cream Sundae

Chocolate, Caramel, Strawberry or Passionfruit

Banana Split

Chocolate, Caramel, Strawberry or Passionfruit

Beer & Spirits

(3)

BEER

	\$
CORONA	9
HEINEKEN 0% / HEINEKEN LIGHT	9
MAC'S GOLD	9
STEINLAGER PURE / STEINLAGER CLASSIC	9
STELLA ARTOIS	9
SPEIGHT'S GOLD	9
TUI	9
DB EXPORT / EXPORT 33 / DB CITRUS	9
BLACK MAC	9
TSINGTAO LAGER	9
TUATARA LAGER	9
TUATARA PALE ALE / APA	9
LION RED	9

SPIRITS - WITH YOUR CHOICE OF SODA

VODKA	11
WHISKEY	11
BOURBON	11
GIN	11
RUM	11
TEQUILA	11
BRANDY	11
GALLIANO	11

PTO



Sharron's Eastern Egret

Soda/Juice? ask us, we have a range including ginger beer, lemonade, cola, orange juice, lemon lime & bitters, grapefruit juice, tomato juice, ginger ale, apple juice and more...all for \$6



Sharron's Eastern Egret



Bottle	Class	Wine Name
36	9	CHURCH ROAD CHARDONNAY
36	9	STONELEIGH CHARDONNAY - MARLBOROUGH
36	9	STONELEIGH SAUVIGNON BLANC
36	9	STONELEIGH REISLING MARLBOROUGH
36	9	CHURCH ROAD PINOT GRIS
SPARKLING		
45	10	DUETZ CUVÉE - MARLBOROUGH
45	10	LINDAUR BRUT
45	10	LINDAUR FRAISE
45	10	BROWN BROTHERS PROSECCO
VARIETAL		
36	9	MATEUS ROSE
RED'S AND PORT'S		
36	9	CHURCH ROAD CABERNET MERLOT
36	9	MONTANNA PINOT NOIR
36	9	WOLF BLASS CABERNET SAUVIGNON
36	9	TAYLORS SHIRAZ
36	9	STONELEIGH PINOT NOIR MARLBOROUGH
10	10	BARROS VINTAGE CHARACTER PORT
10	10	BARROS 10YR OLD PORT

Wine List



Host Responsibility of Intent

.....Management and staff welcome you

4

We wish to ensure that all our customers enjoy themselves and we encourage responsible drinking practices.

- Those under 18 years old will not be served alcohol; please do not be offended if identification is requested.
- Low alcohol beer is available.
- We offer a range of fruit, non alcoholic and hot beverages.
- Intoxicated and aggressive persons will be asked to leave the premises.
- Food is available during opening hours.
- This is a non-smoking environment; there are seats by the bus stops outside for smokers.
- We will dial a taxi or Drive 4 U for your convenience.

Please be our guest 😊. We will endeavour to make your stay a pleasant one.

Fire Evacuation Statement

This statement must be accompanied with all new or renewal applications for on-licence (including BYO licences), off-licence, special and club licences in accordance with section 100 and 127 of the Sale and Supply of Alcohol Act 2012.

1. Applicant details

Premises name:	Add Eastern Egret Restaurant
Applicants name: (Individual or Company)	Add Eastern Egret Limited
Premises address:	Add 4 Ngaio Road, Waikanae
Contact phone:	Home: 04 2934772 Mobile: 0221990991
Contact email:	Add yutangz@gmail.com

2. Fire evacuation scheme

Most commonly a building requires an evacuation scheme because it is used for the following purposes:

- The gathering together, for **any purpose of 100 or more persons**:
- Providing **employment facilities for 10 or more persons**:
- Providing **accommodation for more than 5 persons** (other than in 3 or fewer household units):
- **Storing or processing hazardous substances in quantities exceeding the minimum amounts** prescribed in Schedule 3 of the Fire and Emergency New Zealand (Fire Safety, Evacuation Procedures, and Evacuation Schemes) Regulations 2018.

See Fire and Emergency New Zealand Act 2017 section 75 and 76 for further information.

*If you are unsure that the building has or requires an approved evacuation scheme, check with the **building owner**. For the requirements of an evacuation scheme or to apply for an evacuation scheme, refer to Fire and Emergency New Zealand web site. www.fireandemergency.nz or Contact Fire and Emergency New Zealand, wellingtondistrict-rteams@fireandemergency.nz.*

Statement

I hereby state that (tick one):

the **owner** of the building in which the premises are situated provides and maintains an evacuation scheme as required by section 76 of the Fire and Emergency New Zealand Act 2017;

OR

because of the building's current use, its owner is not required to provide and maintain such a scheme;

OR

because of the nature of the building, its owner is exempt from the requirement to provide and maintain such a scheme.

NOTE:

If an approved evacuation scheme is not required, the building must have evacuation procedures that meet Part 1 of the Fire and Emergency New Zealand (Fire Safety, Evacuation Procedures, and Evacuation Schemes) Regulations 2018 – this does not require approval by Fire and Emergency New Zealand.

Name:

Add Yutang Zhen

Signature:

Add 

Date:

Add 20/01/2026

Submitting applications

Email completed forms to: licence.application@kapiticoast.govt.nz

Post to:

Alcohol Licensing Team
Kāpiti Coast District Council
Private Bag 60601
Paraparaumu 5254

or deliver to:

Kāpiti Coast District Council
175 Rimu Road
Paraparaumu