

150mm
100
50
10mm
0

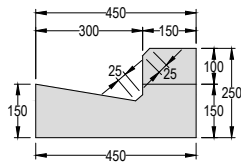

STANDARD KERB AND CHANNEL

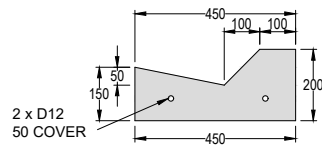

MOUNTABLE KERB AND CHANNEL *
(TRAFFIC ISLAND ONLY)

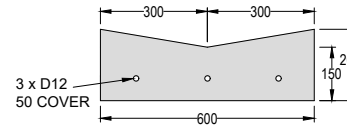

DISH CHANNEL

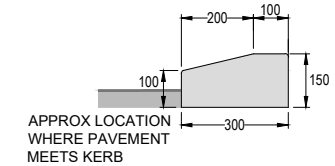

MOUNTABLE KERB *
(TRAFFIC ISLAND ONLY)

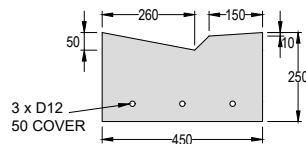

HEAVY DUTY VEHICLE CROSSING
KERB AND CHANNEL

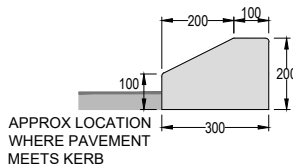

SEMI-MOUNTABLE KERB *
(TRAFFIC ISLAND ONLY)

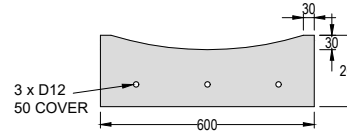

ALTERNATIVE DISH CHANNEL

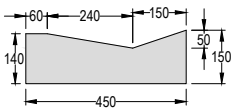

PRAM CROSSING KERB AND
CHANNEL

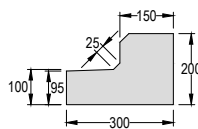

STANDARD KERB ONLY

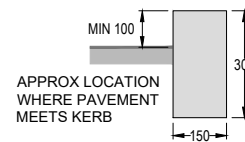

NIB ONLY

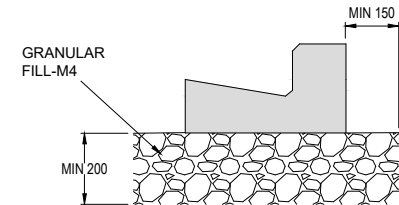

FOUNDATION DETAIL FOR
ALL KERB PROFILES

NOTE:

1. CONCRETE TO HAVE 20MPa COMPRESSIVE STRENGTH.
2. ALL KERBS TO BE LAID ON A MINIMUM 200mm THICK COMPACTED M4 BED.
3. ALL DIMENSIONS SHOWN ON THIS PLAN ARE IN MILLIMETERS UNLESS STATED OTHERWISE.
4. ALL GRANULAR FILL MUST COMPACT AT A MINIMUM OF 30 CLEGG IMPACT VALUE.
5. IF MOUNTABLE KERB PROFILE IS USED, THE ADJACENT FOOTPATH MUST BE REINFORCED WITH 663 MESH
6. MOUNTABLE KERB IS NOT THE PREFERRED PROFILE, ONLY TO BE USED WITH ENGINEER'S APPROVAL ONLY. IT WILL BE ASSESSED ON CASE BY CASE BASIS.
7. KERB RENEWALS REQUIRE SUBSOILS DRAINAGE AS PER KCDC-SW-007

* MOUNTABLE KERB AND SEMI-MOUNTABLE KERB IS NOT THE PREFERRED OPTION (UNLESS USED FOR TRAFFIC ISLANDS) AND CAN ONLY BE INSTALLED AT THE COUNCIL ENGINEER'S WRITTEN APPROVAL, IN ACCORDANCE WITH NZS4404 SECTION 3.3.19.6



STANDARD DETAILS

ROADING STANDARDS
KERB AND CHANNEL DETAILS

Drawn	Designed	
J. GOODMAN		
Approved	Revision Date	
G. O'CONNOR	OCTOBER 2020	
Scale	Drawing No.	Revision
NOT TO SCALE	KCDC-RD-001	R8