

Mayor and Councillors
KĀPITI COAST DISTRICT COUNCIL

17 APRIL 2014

Meeting Status: **Public**

Purpose of Report: For Decision

APPLICATION FOR EXEMPTION UNDER SECTION 6 OF THE FENCING OF SWIMMING POOLS ACT 1987 - 10 MANHATTAN COURT, PARAPARAUMU.

PURPOSE OF REPORT

- 1 The purpose of this report is to consider an application by Julia Day and Dwayne Moffitt for an exemption under Section 6 of the Fencing of Swimming Pools Act 1987 (**the Act**), in respect of a portable spa pool at 10 Manhattan Court, Paraparaumu.

SIGNIFICANCE OF DECISION

- 2 The recommendations in this report do not trigger the Council's significance policy.

BACKGROUND

- 3 The specific exemption requested is for a "*portable spa pool*". This application (**Attachment 1**) is the result of a recent inspection by the Council's monitoring staff and a request by the property owner to seek an exemption from some of the requirements of the Act. The following sections outline details of the application and relevant sections of the Act.

CONSIDERATIONS

Issues

- 4 The spa pool is currently full and fails to comply with the Act as there is no compliant 1.2 metre fence surrounding the immediate spa pool area.
- 5 Section 4 of the Act states that all pools are required to comply with the Act at any time when the pool is filled or partly filled with water.
- 6 The spa pool has been inspected by a Council officer who has confirmed the applicant meets all the criteria for an exemption as set down in the agreed "*Application for Special Exemption for Portable Spa Pool*", as adopted by the Regulatory Management Committee on 27 April 2006 with the exception of the warning sticker which Council will supply. The application also meets the requirements of "*New Zealand Standard 8500:2006 Safety Barriers and Fences Around Swimming Pools, Spas and Hot Tubs*". The applicant has also signed the "Statement of Undertaking". The property meets restricted access requirements.

- 7 It is the opinion of the reporting officer that this application could be approved subject to the conditions listed in the “Recommendations” being met because the applicant’s proposal would not significantly increase danger to young children. The application is similar to others that the Regulatory Management Committee has previously considered and granted, subject to similar conditions.

Financial Considerations

- 8 There are no financial considerations.

Legal Considerations

- 9 The Council is required to address the matters as set out in the Act and if it were to grant an exemption the Council must be satisfied, having regard to the particular characteristics of the property, the pool and any other relevant circumstances, that such an exemption would not significantly increase the danger to young children.
- 10 If the Council was to grant an exemption under section 6(1) of the Act, then it may impose such other conditions relating to the property or the pool as are reasonable in the circumstances.
- 11 Any exemption granted or condition imposed under this section may be amended or revoked by a territorial authority, by resolution.

Delegation

- 12 The Council has the authority to make this decision.

RECOMMENDATIONS

- 13 That the Council approves the application for exemption under Section 6 of the Fencing of Swimming Pools Act 1987 and not require a fence to be placed around a portable spa pool at 10 Manhattan Court, Paraparaumu, subject to the following conditions being complied with:
- The pool has a height of 760mm or greater above ground or deck level and no objects are positioned so as to allow a young child to climb onto the cover; and
 - The property has suitable barriers in place to prevent a child up to the age of six years gaining access from outside the property, and the lockable spa cover meets the set criteria as stated below:
 - the cover is lockable and able to be kept locked when the pool is not being used or supervised;
 - the locks cannot be opened or released by a child up to the age of six years;
 - the cover cannot be lifted more than 100mm above the top of the spa, when locked in place;

- the cover must be made of material that can withstand the weight of at least 60 kgs to ensure that it would withstand the weight of a child up to six years;
- the cover must be constructed of a suitable material and not allow water to pond on top of it;
- the cover and locks must be maintained in a good state of repair; and
- suitable warning stickers/signs be placed on the cover to advise that it must be locked in place when the pool is not being used or supervised.

Report prepared by:

Approved for submission by:

**Peter Ropata
COMPLIANCE OFFICER**

**Tamsin Evans
GROUP MANAGER
COMMUNITY SERVICES**

Approved for submission by:

**Wayne Maxwell
GROUP MANAGER
CORPORATE SERVICES**

ATTACHMENTS:

1. The application
2. Non-compliant pool letter
3. Photo

Attachment 1:

EP/05/02/10/02

\$242.00 Rept attached #463664



**APPLICATION FORM
SPECIAL EXEMPTION FOR PORTABLE SPA POOL
UNDER SECTION 6 OF THE FENCING OF SWIMMING POOLS ACT 1987**

Application for an exemption for spa pool is made in accordance with the details set out below:

1. Physical address of property where spa pool is sited: 10 Manhattan Court, Paraparaumu Beach
2. Full name and address of property owner: Julia Kathryn Day & Dwayne Ian Moffitt
3. The property is occupied by: owner tenant
4. Contact details of owner
 Day time phone contact number: 0275495900 - Julia
 After hours phone contact number: 042982287
 Fax number: /
 Email address: dwayneandjulia@extra.co.nz
5. This application for exemption relates to a portable spa pool (see overleaf)
6. I believe my portable spa pool meets all the conditions specified by Council: Yes No
7. If no, specify any points that you believe may not comply:

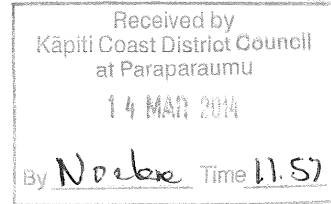

Application is made by: [Signature]
(signature of owner)

28/02/2014
(date)

All the relevant information on this form is required to be provided under the Fencing of Swimming Pools Act for Kāpiti Coast District Council to process your application. Under this Act, this information has to be made available to members of the public including business organisations. The information contained in this application may be available to other departments of Council. You have the right to access the personnel information held about you by the Council which can be readily retrieved. You can also request that the Council correct any personal information it holds about you.

This application must be accompanied by:

- **Application Fee**
- A site plan showing the subject of this application (if considered necessary)
- Photographs showing the spa pool relating to this application

FOR OFFICE USE ONLY GL Code

Date Received: 14/03/2014

Hearing Date: 10 April 2014

Receipt Number: 463664

Exemption: Granted Declined

Applicant Notified: _____

Pool Register updated: _____

Special Exemption for Spa Pool under Section 6 of the Fencing of Swimming Pools Act 1987 can be considered for portable spa pools, where:

- The pool has a height of 760mm or greater above ground or deck level and no objects are positioned so as to allow a young child to climb onto the cover. ✓
- The property has suitable barriers in place to prevent a child up to the age of six years gaining access from outside the property, and the lockable spa cover meets the set criteria as stated below: ✓
 - The cover is lockable and able to be kept locked when the pool is not being used or supervised. ✓
 - The locks cannot be opened or released by a child up to the age of six years. ✓
 - The cover cannot be lifted more than 100mm above the top of the spa, when locked in place. ✓
 - The cover must be made of material that can withstand the weight of at least 60kgs to ensure that it will more than take the weight of a child up to six years. ✓
 - The cover must be constructed of suitable material so the water will not pond on top of it. ✓
 - The cover and locks must be maintained in a good state of repair. ✓
 - That suitable warning stickers/signs be placed on the cover to advise that it must be locked in place when the pool is not being used or supervised. ✓
 - That the property owner/tenant sign a statement of undertaking, taking full responsibility to ensure the above requirements are adhered to. ✓

Statement of Undertaking

I (insert name) Julia Day being the owner/tenant of the property detailed in the above application do hereby give my undertaking accepting full responsibility to ensure that the condition attached to my application for exemption under the Fencing of Swimming Pools Act 1987 will be adhered to at all times that the spa pool is filled.

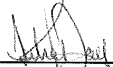
Signed: 
 Date: 28/02/2014

Witnessed by Name: Dawn Kearworth
 Signature: 
 Date: 28/2/2014

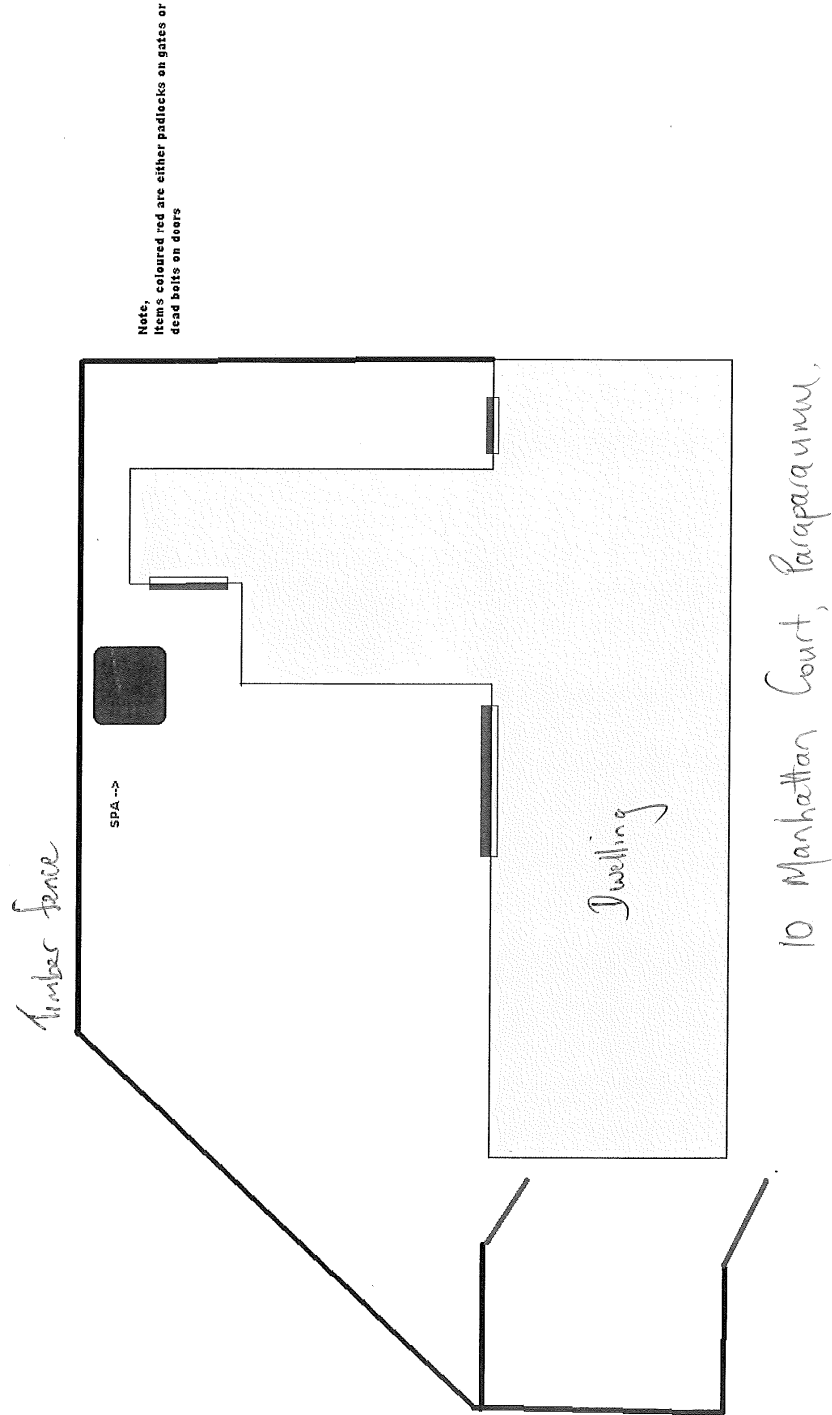

Attachment 2:

25 February 2014

File: SW1825

Julia Day
Dwayne Moffitt
10 Manhattan Court
PARAPARAUMU 5032

Dear Julia & Dwayne

NON COMPLIANT POOL FENCING - 10 MANHATTAN COURT, PARAPARAUMU

An inspection of the above property on 25 February 2014 for the purposes of determining compliance with the Fencing of Swimming Pools Act 1987 (**the Act**), revealed the pool was not fenced in accordance with the Act.

The Act requires that the pool is not filled or partly filled with water until such time as the pool or the immediate pool area complies with the Act and compliance has been confirmed by a further visit from a Council officer. (**Note: an empty pool does not breach the Act**).

The pool fencing fails to comply with the Act in the following areas:

- At the time of the inspection the spa pool water depth exceeded 400mm and was not fenced in accordance with the Fencing of Swimming Pools Act 1987.

Please ensure the compliance work is undertaken, or the pool is emptied as described above by 25 March 2014. Please contact me before this date to arrange a re-inspection.

If you have any questions, you may contact me on (04) 296 4700.

Yours sincerely

Peter Ropata
COMPLIANCE OFFICER

Attachment 3:

The spa pool is measured at a height of 760mm above ground level.



The timber fence at the rear of the spa pool has been rendered non-climbable by attaching a metal triangular fillet to the bottom rail of the fence.

