

WAIKANAE TOWN CENTRE PROJECTS

MAHARA PLACE UPGRADE



WORKING TOGETHER



Workshop themes

*Access/connectivity
Arts/music thriving
Businesses/living
Green/sensory
Lighting/safety*

*Caters for all
Vibrant destination
Identity
Flexible/timeless
Shelter*



OUR VISION FOR MAHARA PLACE

We've been working with the Mahara Place Development Committee (made up of community and business reps) to further develop concepts for improvements to Mahara Place.

The idea is to help make Mahara Place the heart of the town centre; one that's vibrant, inclusive, and well-connected.

It's been exciting to work together to take the ideas from previous conversations with the community and develop these further.

We've budgeted \$1 million for the Mahara Plaza. There are other things like the laneways, Mahara lane, a new playground and the entranceway by the Library that we'd like to work on too, if further funding becomes available.

to Marae
and carpark

LANEWAY

Possible improvements to the laneways into Mahara Place. Mahara Place is an internally focused space. The entrances are important for advertising Mahara Place and leading people into the town centre.

to Marae
and carpark

LANEWAY

MAIN ENTRANCE SH1

State Highway 1

Possible
upgrade of the
playground

PLAYGROUND

PLAZA

Gallery

Library

Mahara square lacks places that encourage people to stop and spend time. The concept for a plaza looks to create a terraced area in the sunniest most sheltered part of the square. It also includes 'reading gardens' that allow people to sit and enjoy being there without feeling like they are on display. The plaza concept allows for formal and informal seating, and spaces that are comfortable for both groups and individuals.

Possible improvement of the Library and Gallery entrances and facades to better relate to Mahara Place. This includes the creation of an iconic, sculptural awning that acts as a gateway to Mahara Place.

MAHARA LANE
Possible future landscaping
improvements.

Improvements to the State Highway 1 entrance will be timed to coincide with the NZ Transport Agency's revocation work to turn SH1 into a local road.

PLANNED CONCEPT FOR MAHARA PLAZA

We're planning to work on the detailed designs for Mahara Plaza over the next few months, and aim to start construction in 2019.

These are concepts only. The materials, surfaces and planting ideas shown are conceptual and yet to be worked through.

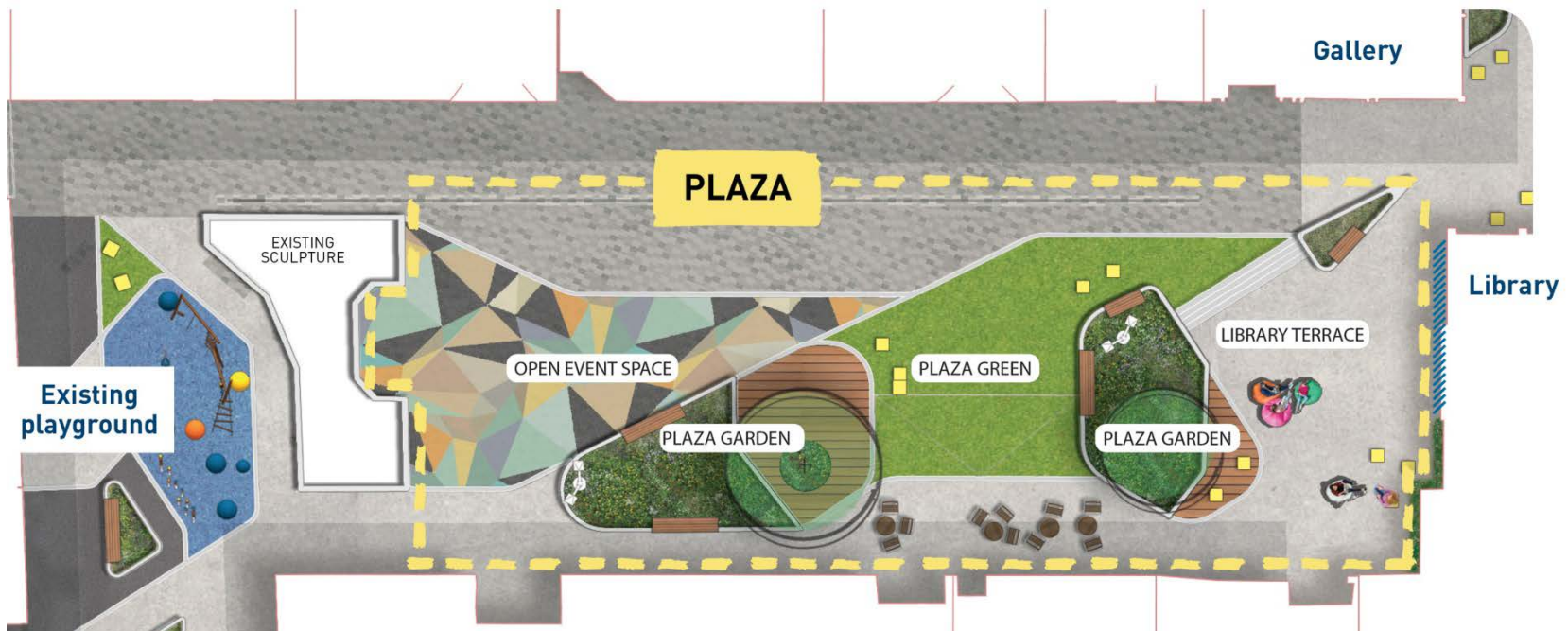

WHAT ELSE WOULD YOU LIKE TO SEE?

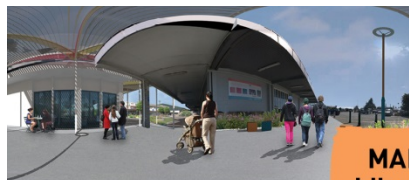

MAIN ENTRANCE
Library and Gallery
(Artist's impression)



Artist's impressions
of possible laneway
improvements.



NEXT STEPS

- **Community board to endorse designs**
- **Council to sign off designs**
- **Public information sessions**
- **Detailed design**
- **Working with retailers and business owners around development opportunities**
- **Construction around February 2019**

